



PLANNING & CAMPUS DEVELOPMENT
OFFICE OF SPACE MANAGEMENT

TOTAL FLOORS: 5
TOTAL GROSS SQUARE FEET: ?
FLOOR: FLOOR: 4
GROSS SQUARE FEET: ?

MAIN ENTRANCE

SECONDARY ENTRANCE

GEORGE PEARL HALL

FOURTH FLOOR
2401 CENTRAL AVE NE

#195

5 OF 5
195-00-04

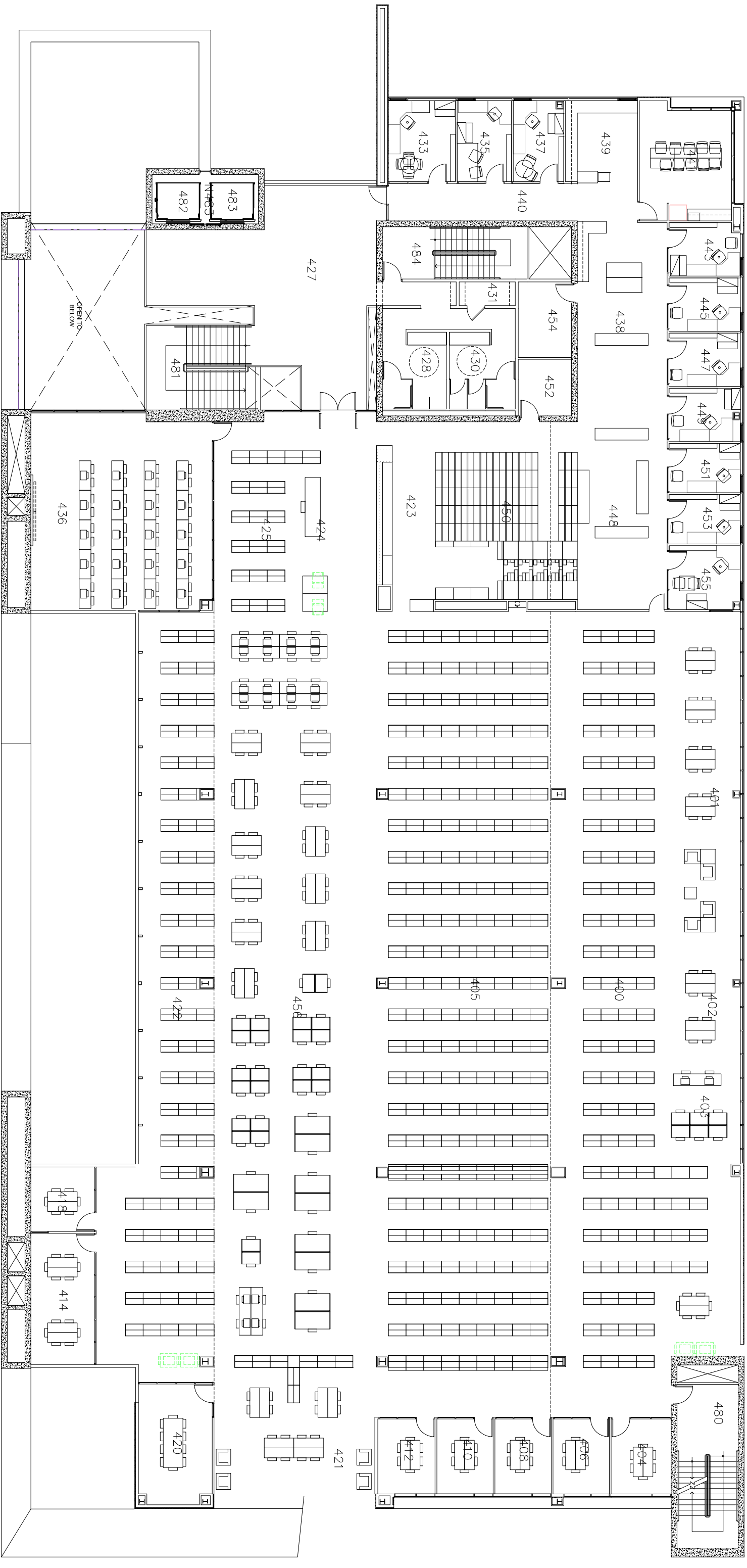

FOURTH FLOOR

SCALE: NOT TO SCALE

